

DATED

13th November 1970

T854

THE COUNTY COUNCIL OF THE
ADMINISTRATIVE COUNTY OF THE
PARTS OF HOLLAND LINCOLNSHIRE

to

THE LINCOLN DIOCESAN TRUST
AND BOARD OF FINANCE

Conveyance

of

1.34 acres of land situate in
the Parish of West Pinchbeck
in the County of Lincoln.

PRESENTED

16 NOV 1970

No. 38911

This Deed

is made the *Hundredth*-
day of *November* One

thousand nine hundred and seventy B E T W E E N THE COUNTY COUNCIL OF

THE ADMINISTRATIVE COUNTY OF THE PARTS OF HOLLAND LINCOLNSHIRE (herein-

after called "the Council") of the one part and THE LINCOLN DIOCESAN TRUST

AND BOARD OF FINANCE (a Company duly incorporated and hereinafter called

"the Diocesan Trust") of the other part

W H E R E A S :

(1) The Council are seized in fee simple in possession free from incumbrances of the land hereinafter described (hereinafter called "the said land") together with other land

(2) The Council have provided the said land as a site for the West Pinchbeck Church of England (Controlled) School (hereinafter called "the School")

(3) The School is a Controlled School within the meaning of the Education Act 1944 and on the Seventeenth day of September One thousand nine hundred and seventy an Order was made by the Secretary of State for Education and Science under Section 16(1) of the said Act authorising the transfer of the School to the new site comprising the said land

(4) The School is the school of the Educational Foundation called the West Pinchbeck Church of England (Controlled) School Foundation (hereinafter called "the School Foundation") whereof the Diocesan Trust has been duly appointed to be the Custodian Trustee

(5) By virtue of the provisions of the Education Acts 1944 and 1946 it is the duty of the Council to convey their interest in the said land to the Diocesan Trust

NOW THIS DEED WITNESSETH as follows :-

1. In consideration of these presents and in compliance with the provisions of the aforementioned Acts the Council as Beneficial Owners hereby convey unto the Diocesan Trust ALL THAT plot of land containing 1.34 acres or thereabouts situate in and fronting to Leaveslake Drove West Pinchbeck in the County of Lincoln and being part of Number 1355 on the Ordnance Survey Map Sheet CXXXIII - 12 (Second Edition 1904) which said plot of land is for the purpose of identification only more particularly delineated on the plan annexed hereto and thereon coloured pink TO HOLD the said land UNTO the Diocesan Trust in fee simple to the intent that the said land shall be held by the Diocesan Trust as Custodian Trustee of the School Foundation UPON TRUST to permit the same to be conducted and used as and

for the purposes of a voluntary school within the meaning of the Education Acts 1944 to 1968 for the education of children living in or near to West Pinchbeck aforesaid wherein religious instruction shall be given in accordance with the doctrines of the Church of England

2. The Council hereby acknowledges the right of the Diocesan Trust to production of a Conveyance dated the Ninth day of November One thousand nine hundred and sixty two and made between Rose Saxton and Frank Saxton of the first part Joyce Maples of the second part and the Council of the third part (the possession of which is retained by the Council) and to delivery of copies thereof and hereby undertakes with the Diocesan Trust for the safe custody of the same

3. It is hereby certified that the transaction hereby effected does not form part of a larger transaction or of a series of transactions in respect of which the amount or value or the aggregate amount or value of the property conveyed or transferred exceeds Five thousand five hundred pounds

IN WITNESS whereof the Council and the Diocesan Trust have caused their respective Common Seals to be hereunto affixed the day and year first before written

THE COMMON SEAL OF THE HOLLAND COUNTY COUNCIL)
was hereunto affixed in the presence of :-

W. H. Smith

A Member of the Council

Donald J. Ford

Clerk of the County Council



THE COMMON SEAL OF THE LINCOLN DIOCESAN TRUST)
AND BOARD OF FINANCE was hereunto affixed in
the presence of :-

Peter B. Russell

A Member of the Trust having
the custody of the key of
the Common Seal

W. J. Leppard
Secretary



MEMORANDUM:

By a Conveyance made the 3rd November 1987 between The

(formerly the
part and Linds
land situate i
being a moiety
thereabouts (E
deed) was con
to production
acknowledged

MEMORANDUM:

Lincoln Diocese:
Gordon Markham
of land contain
Pinchbeck Linc
and comprising
Plan (1904 Ed
Written Convey
Mavis Doreen E
and delivery o

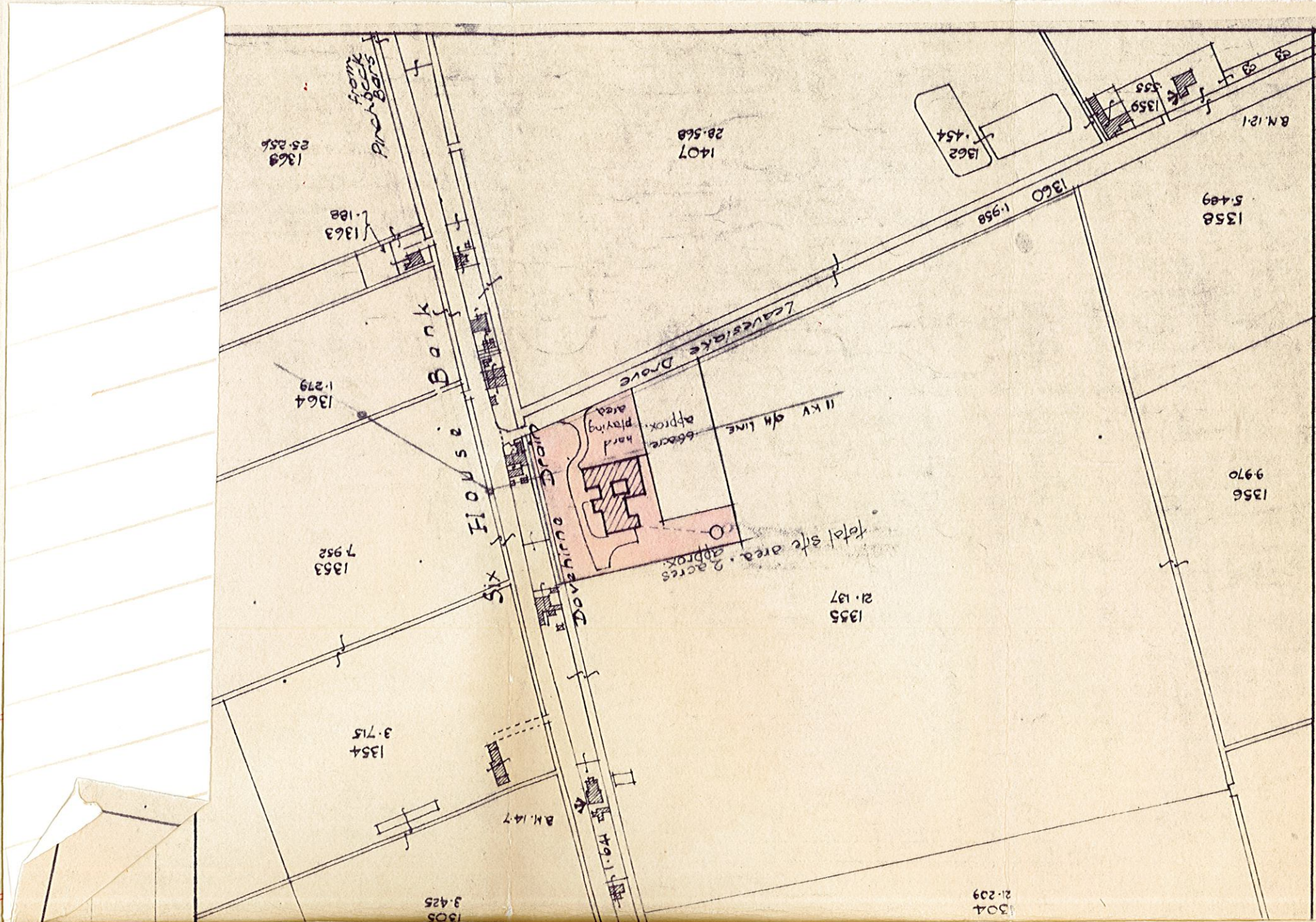

MEMORANDUM: By a Conveyance made the 3rd November 1987 between The Lincoln Diocesan Trust and Board of Finance Limited (formerly the Lincoln Diocesan Trust and Board of Finance) of the one part and Linda Louise Reynolds of the other part a piece or parcel of land situate in West Pinchbeck forming part of O.S.No.1355 (1904 Edition) being a moiety of a length of dyke comprising 270 square yards or thereabouts (part of the property comprised in the within written deed) was conveyed to the said Linda Louise Reynolds and her right to production and delivery of copies of the within written deed was acknowledged

MEMORANDUM: By a Conveyance made the 3rd July 1989 between The Lincoln Diocesan Trust and Board of Finance Limited (formerly The Lincoln Diocesan Trust and Board of Finance) of the one part and Keith Gordon Markham and Mavis Doreen Elsie Markham of the other part a piece of land containing 135 square yards or thereabouts situate at West Pinchbeck Lincolnshire and forming part of the Dovehirne Drainage Ditch and comprising part of the enclosure number 1355 on the Ordnance Survey Plan (1904 Edition) and being part of the property comprised in the within written Conveyance was conveyed to the said Keith Gordon Markham and Mavis Doreen Elsie Markham in fee simple and their right to production and delivery of copies of the within written deed was acknowledged

the Education
near to West
iven in

Trust to
ne thousand
Frank Saxton
uncil of the